

# Makertech

## DSE Only - Stage 00: Unboxing and Introduction

Written By: Makertech



# INTRODUCTION

The Dual Switching Extruder build manual for a non-Proforge printer will assume that you already have an understanding of open-source rewrap 3d printing and are comfortable editing the Marlin firmware for your own specific set-up.

## Step 1 — Unboxing



- When unboxing you should have:

- Fasteners
- Cables
- Electronics
- Hotend x2
- Metal Parts
- NEMA 17 Motor

## Step 2 — Fasteners Bag



- Spacers and Bearings
- Fastener Bag A
- Fastener Bag B
- Cable Ties
- Braided Cable Sleeving
- PTFE Tape

## Step 3 — Electronics Bag

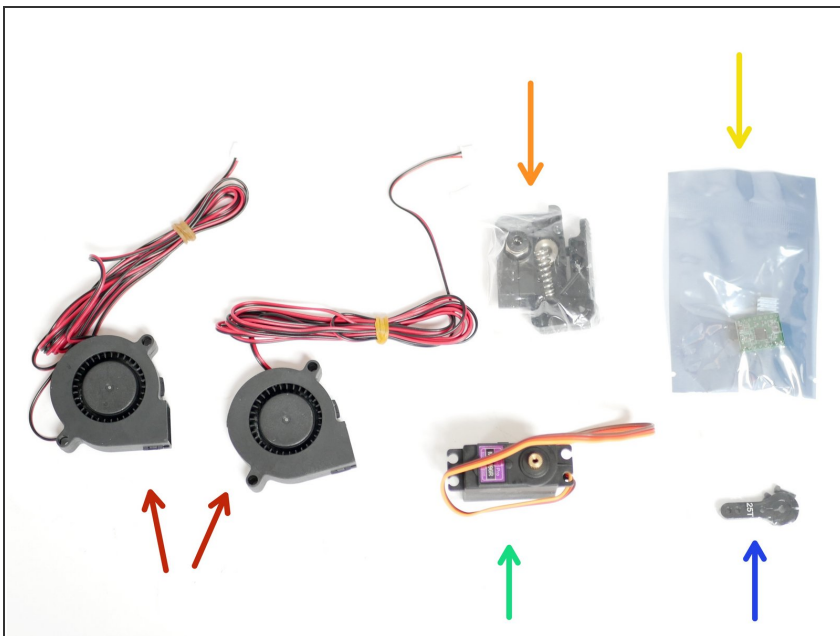

- Blower Fan x2
- Extruder Kit
- Stepper Driver
- Servo Motor
- Servo Arm

## Step 4 — Cables Bag

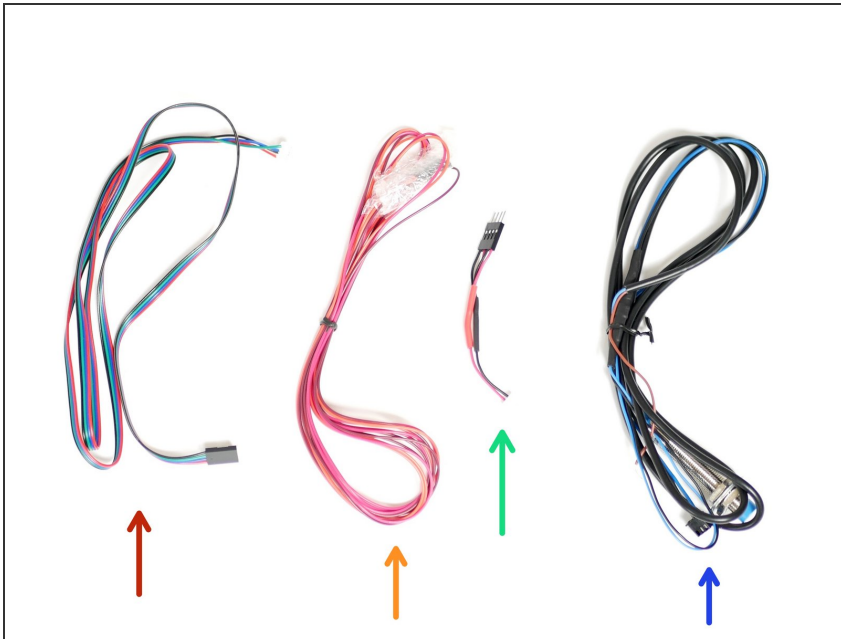

- Motor Cable
- Servo Cable
- Fan Adapter Cable
- Levelling Probe

## Step 5 — Metal Parts Bag

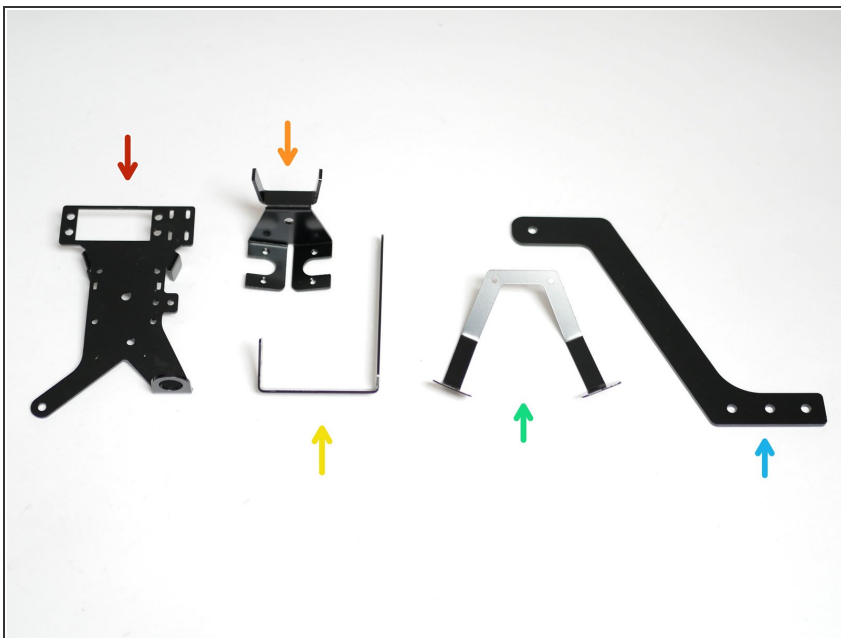

- DSE Backplate
- DSE Hotend Mount
- 2nd Fan Mount
- Ooze Shield
- Spool Holder

## Step 6 — You Will Need (not included)



- Allen Keys
- Scissors
- Needle Nose pliers
- Slip Joint Pliers
- A lighter (optional)

## Step 7 — Hardware Requirements



- Electronics board capable of running two extruder motors.
- At least one bowden extruder feeder.
- A metal print platform for using the included probe.
- 12V or 24V power supply.

## Step 8 — Firmware Requirements



- Latest version of the Marlin firmware with "SWITCHING\_NOZZLE" feature.
- Other firmwares may also be compatible, but are untested.

## Step 9 — Software Requirements



- A slicer with dual extrusion support. We recommend Cura.
- A slicer capable of X/Y dual hotend offset.

## Step 10 — Forum/Troubleshooting - Here to Help!



- ❗ If you get stuck at any point or need help with assembly or printing something, feel free to post in the official [forum](#).
- ❗ If you're missing a part or have received a faulty/broken one, please use this form [here](#) to order a replacement.
- ❗ Want to get in touch? Drop us an email at [info@makertech3d.com](mailto:info@makertech3d.com)