

Makertech

Stage 05 -Tool Carriage

Written By: Makertech



Step 1 — Dual Switching Extruder



i If you are building the Dual Switching Extruder complete **only steps 7 and 8** of this stage.

Step 2 — Print Fans to Hotend Mount

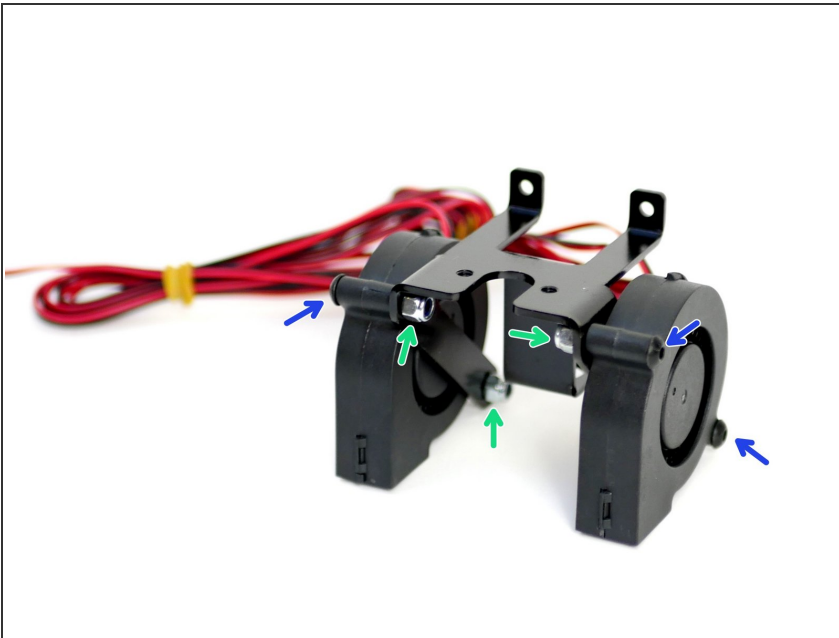

i Fix both of the blower fans to the sides of the Hotend Mount.

- M4 x 22mm
- M4 Nyloc Nut

Step 3 — Mounting the HotEnd

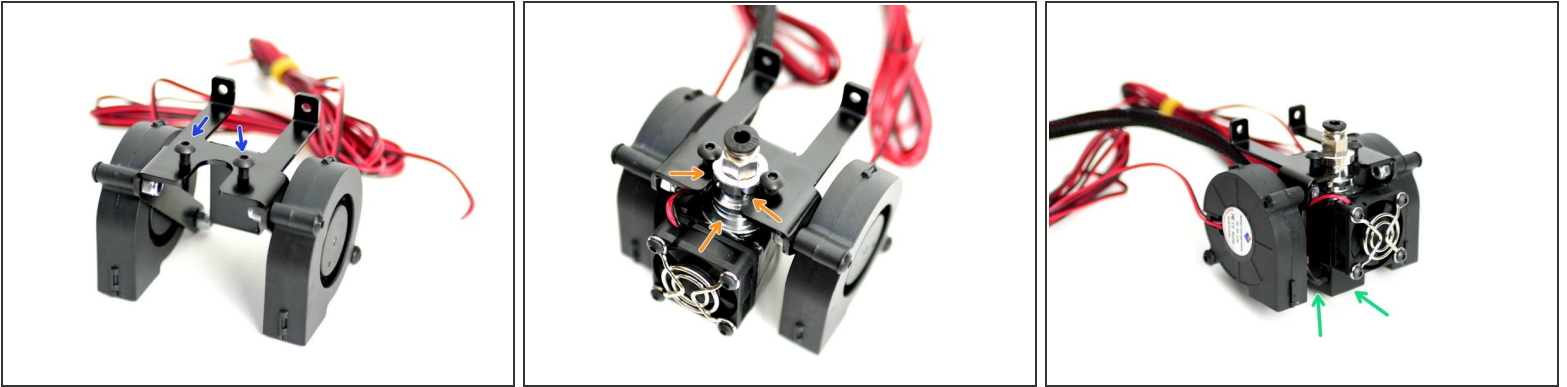

- Thread two M4 x 8mm bolts onto the top of the HotEnd bracket.
- Slide the HotEnd in and clamp it down with the two M4 bolts.
- Keep the this side of the HotEnd parallel with the front of the Hotend Mount
- Make sure that the cables from the Hotend are facing the left side.

Step 4 — Bed Levelling Probe

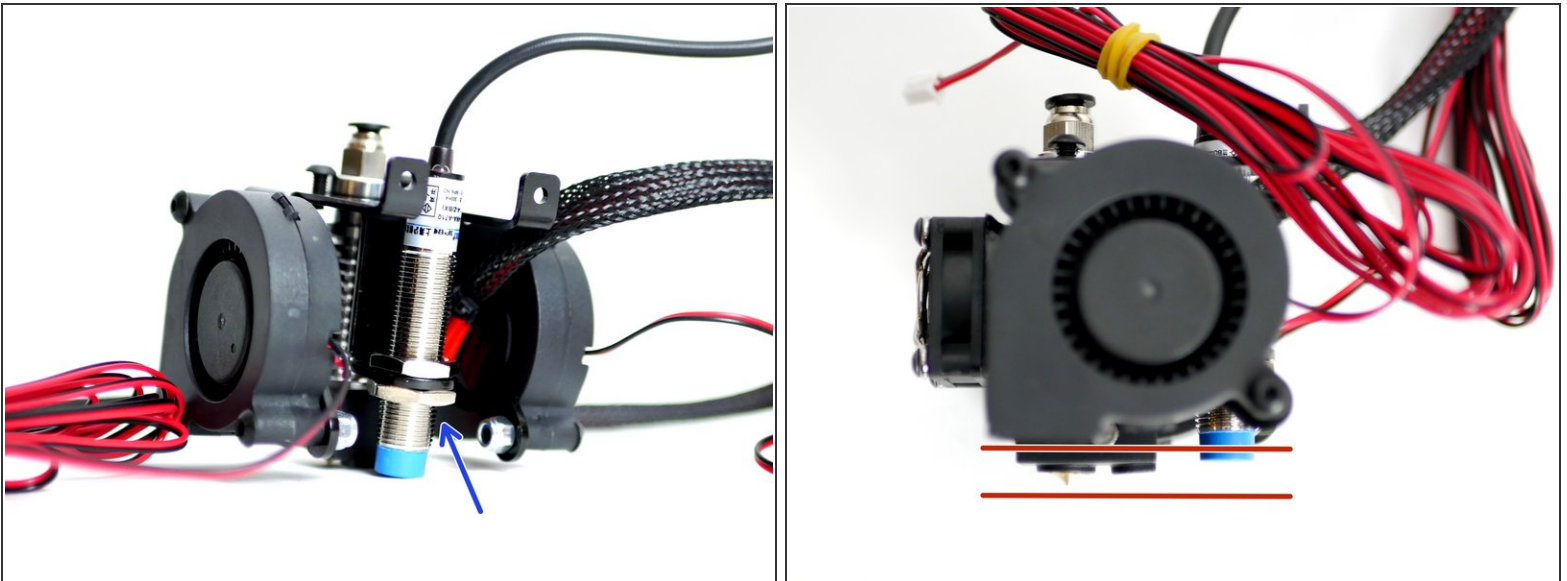

- Clamp the probe onto the back of the Hotend Mount.
- Keep the bottom of the probe a few millimeters **above** the tip of the nozzle.

Step 5 — Braided Cable Sleeving Prep.

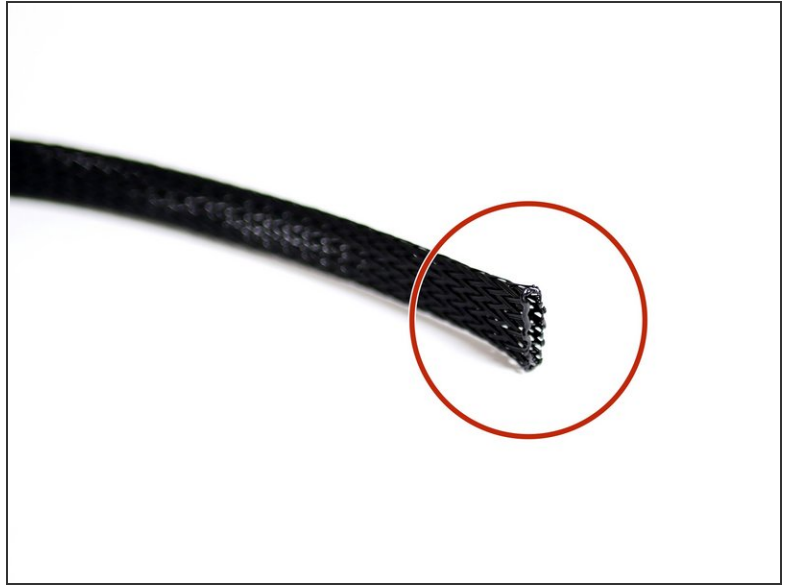
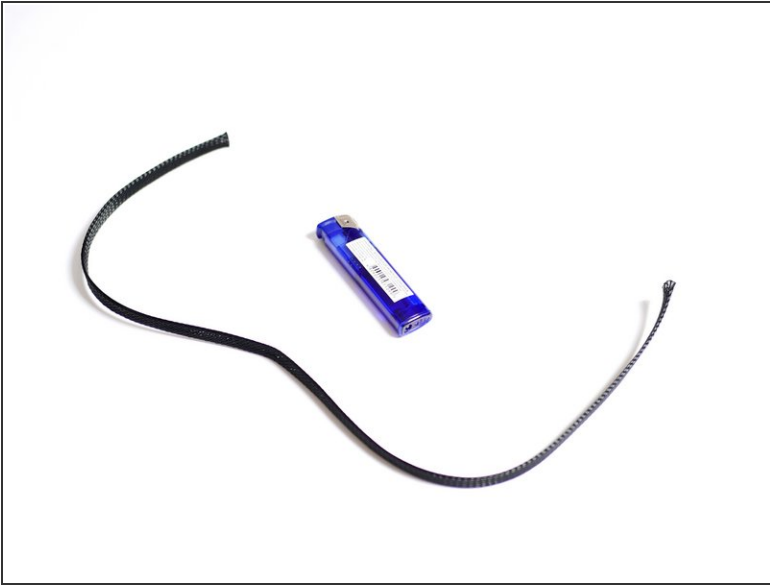

- ① Cut 1 meter of the braided cable sleeving.
- Melt the ends with a lighter to prevent fraying.

Step 6 — Braided Cable Sleeving

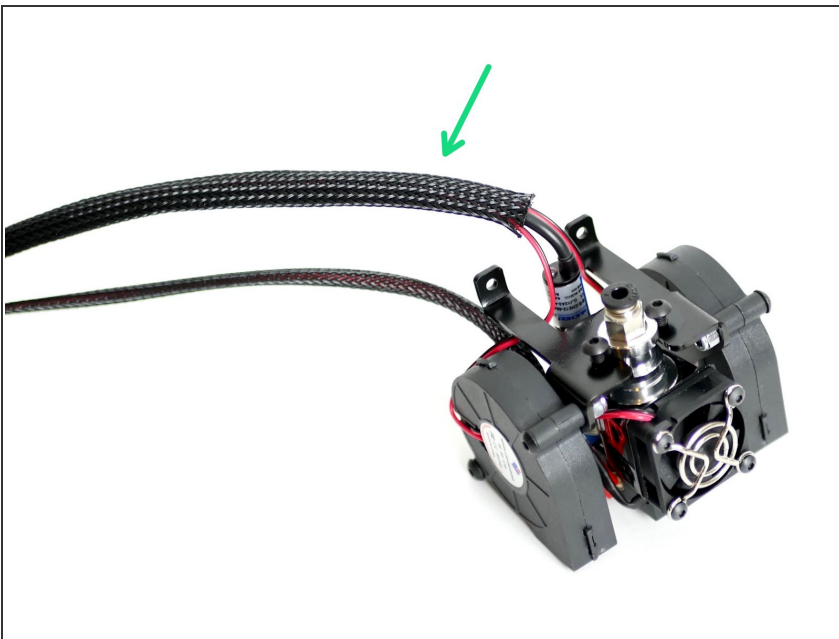

- Slide the cable sleeving over the blower fan and probe cables.

Step 7 — Braided Cable Slewing (Dual Extruder Only)

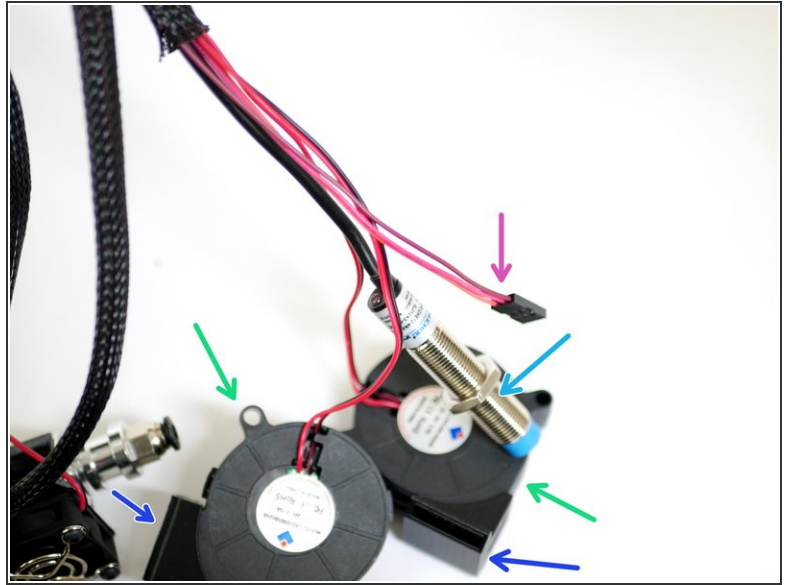
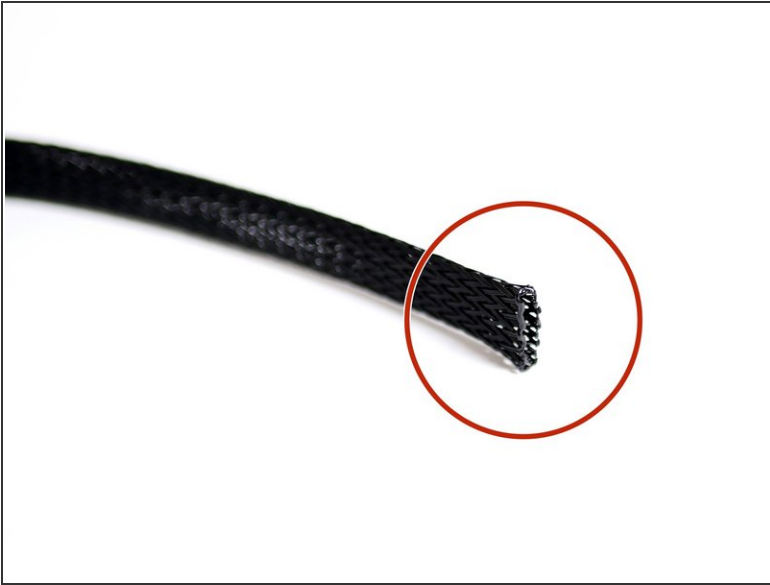





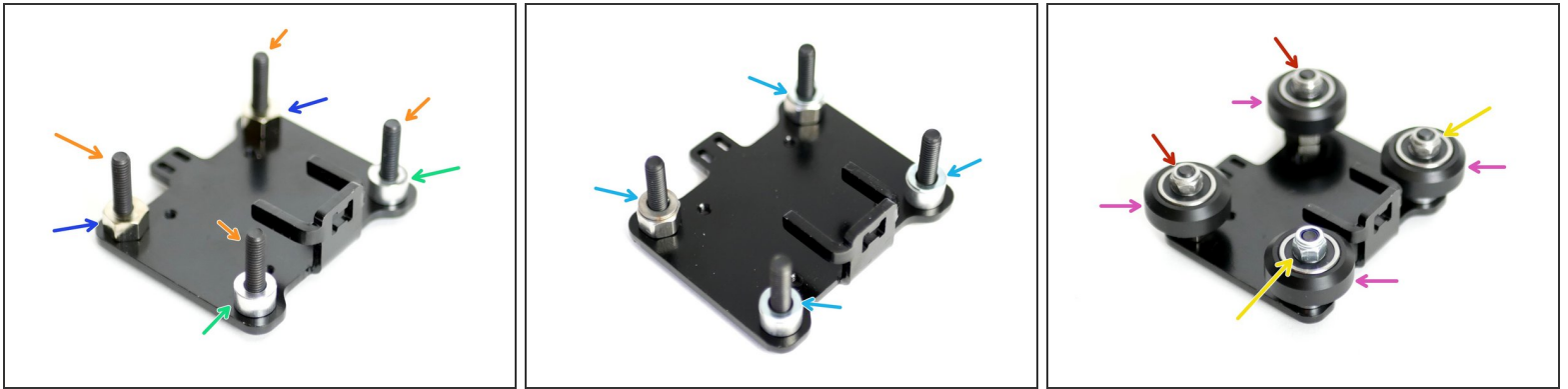

- ① Cut 1 meter of cable sleeving.
 - Melt the ends with a lighter to stop them from fraying.
- ① Slide the sleeving over the cables from:
 - Blower Fan (x2)
 - Probe
 - Servo Cable (From the Dual Extruder Upgrade box)
 - You can also snap on the fan shrouds here too.
- ① Place this assembly to one side for now.

Step 8 — Y-Carriage Rollers



 Assemble Y-Carriage rollers as shown in the images:

-  Four M5 x 25mm bolts
-  Two M5 Spacers
-  Two Eccentric Spacers
-  Four M5 Washers
-  Roller Assembly
-  Two M5 Nylocs - **Tighten Firmly**
-  Two M5 Nylocs - **Tighten Loosely (eccentric spacer should still be able to turn)**

Step 9 — HotEnd mount to Y-Carriage

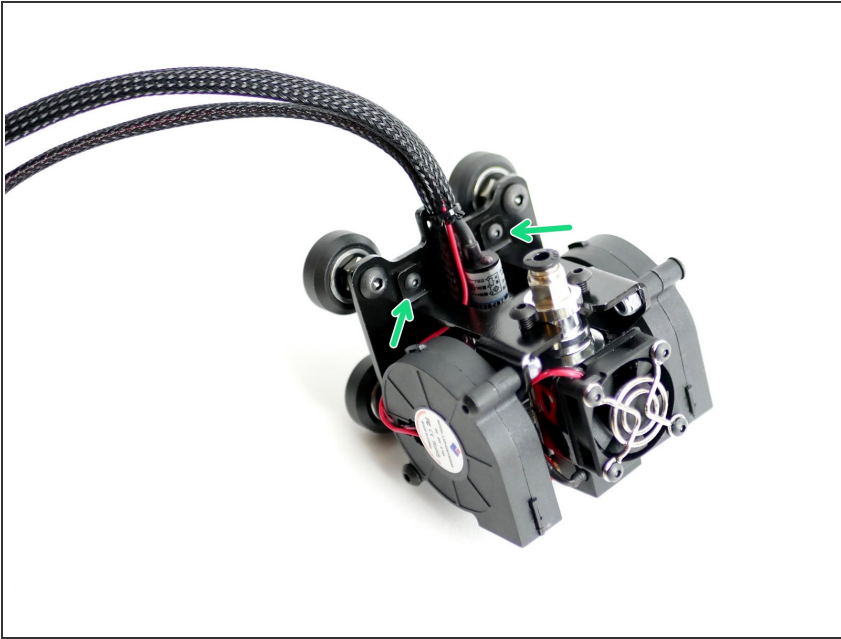

❗ Fix the HotEnd Mount assembly onto the Y-Carriage.

- M3 x 8mm bolt

Step 10 — Fan Shrouds

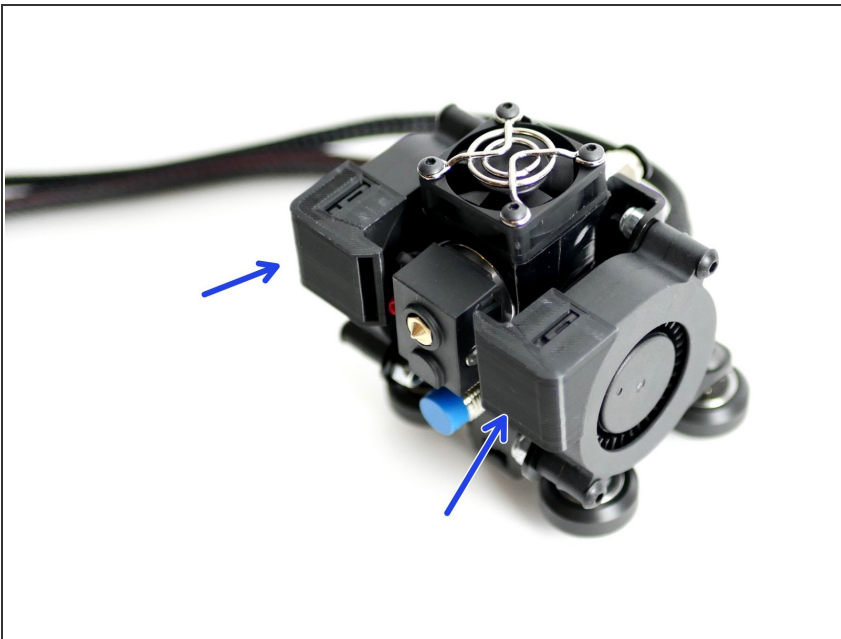

- Snap both of the 3D Printed Fan Shrouds onto the Blower Fans.